

# TN-700D Series Sewing Machine

## INSTRUCTION MANUAL



# INSTRUCTIONS FOR TN-700 SERIES MACHINES

## PREFACE

This manual has been prepared to guide you while operating TN-700 series machines and arranged to simplify ordering spare parts.

This manual explains in detail the proper settings for operation of the machines. Illustrations are used to show the adjustments and reference letters are used to point out specific items discussed.

Careful attention to the instructions and cautions for operating and adjusting these machines will enable you to maintain the superior performance and reliability designed and built into every sewing machine.

Adjustments and cautions are presented in sequence so that a logical progression is accomplished. Some adjustments performed out of sequence may have an adverse effect on the function of the configuration in illustrations or cautions.

On the following pages will be found illustrations and terminology used in describing the instructions and the parts for your machine.

In addition to the instructions and to the mandatory rules and regulations for accident prevention and environmental protection in the country and place of use of the machine/unit, the generally recognized technical rules for safe and proper working must also be observed.

The instructions are to be supplemented by the respective national rules and regulations for accident prevention and environmental protection.

Subject to change without notice







# CONTENTS

PREFACE.....	2
SAFETY RULES.....	4
GENERAL SAFETY .....	5
IMPORTANT SAFETY INSTRUCTIONS .....	6
APPLICATION OF THIS INSTRUCTION MANUAL.....	6
STYLES OF MACHINES.....	7
TN-737D.....	7
TN-747D.....	7
TN-757D.....	7
PARTS OF THE MACHINE .....	8
INSTALLATION.....	9
HANDLING YOUR MACHINE .....	11
BREAK IN PERIOD.....	12
LUBRICATION.....	12
THREADING.....	14
TENSIONS.....	17
NEEDLES.....	18
CHANGING THE STITCH LENGTH .....	19
CHANGING THE DIFFERENTIAL FEED .....	20
ADJUSTING / REPLACING BLADES.....	21
REPLACE THE UPPER BLADE .....	21
REPLACE THE LOWER BLADE .....	21
ADJUST THE HEM / CUTTING WIDTH .....	22

## SAFETY RULES

**IMPORTANT!** Before putting the machine into service, also read the safety rules and instructions from the motor supplier.

Explanation of safety labels

 DANGEROUS	Do not ignore this warning sign and do not proceed with incorrect operation. Doing so may cause serious personal injury.
 CAUTION	Ignoring this warning sign and proceeding with incorrect operation will cause machine and/ or operator damage.
	Moving parts – Please proceed with caution
	High voltage, beware of electrical shock
	High temperature, beware of burns
	Prohibited
	Grounding wire

## **GENERAL SAFETY**

When using these machines, basic safety precautions should always be followed to avoid the risk of fire, shock or personal injury. Follow all instructions in this manual to get the most out of your machine.

- Keep your work area clean: Cluttered workspaces and benches can cause injury and damage to machinery.
- Always consider your work environment and operate according to basic safety factors: Electricity and fluids do not mix. Do not use any machinery in wet or damp areas and always be aware of shock or damage when working with power and power tools.
- Keep children and pets away from machinery: Sewing machines are considered high risk and can cause serious damage. Always keep children or pets away when operating machinery
- Dress properly when operating machines: Do not wear loose clothing or jewelry as these may get caught in the machinery and cause serious damage.
- Always be cautious of cables and cords and inspect regularly for damage to these: Keep the cords away from heat, chemicals, and any sharp instruments.
- Maintain the machine with care: Following these instructions for lubrication and adjustments should be the priority when operating your machine. Not doing this can cause serious long-term damage to the machine and even the operator.
- Disconnect machine when not in use: Always unplug the machine when not in use or when adjusting or making changes to the machine configuration.
- Do not use any other parts or accessories unless authorized by a qualified technician
- Always make sure your machine is repaired by a qualified repair person.

## **IMPORTANT SAFETY INSTRUCTIONS**

To operate safely and getting the most out of your machine investment, please read and follow this manual. Keep this manual close for all references. We are confident that you will enjoy this machine as much as we enjoyed manufacturing it for you.



- Before using your machine, please make sure you read this manual completely and follow all basic safety measures.



- Do not modify this machine without confirming this with your qualified technician or with Titan Sewing directly.



- When using this machine, all safety equipment and precautions should be in place to allow a safe environment for the machine and operator.



- This machine needs to be operated by a properly trained operator.



- For your own safety, we recommend protective eyewear.



Hazardous voltage can cause injury. Turn off the machine before opening the control box or connecting any cables or cords

When there is a need to open the control box, please turn off the machine and wait 5 mins before opening the control box to allow the latent power to dissipate



- Always turn off the power when changing needles / guides / interchangeable parts or adding /removing any accessories or devices.

## **APPLICATION OF THIS INSTRUCTION MANUAL**

**NOTE:** Instructions stating direction or location such as right left, front or rear of machine, are given relative to operator's position at the machine, unless otherwise noted. The handwheel pulley rotates clockwise, in operating direction, when viewed from the right end of machine.

## **STYLES OF MACHINES**

The TN-700 series of machine is normally split up into (3) categories but not limited to these. Future expansion may expand these categories

**TN-737D:** This model is a 3 thread, single needle overcast only machine used traditionally for only overcasting the edge seams. Can be used on knits or woven materials.

Seam specification: ISO# 504 Overedge formed by 1 needle thread and 2 looper threads producing a purl on the edge of the seam.

Sewing capacity: up to 5mm

Standard needle: B27 (DCx27) #10/70~14/90

Stitch length: Up to 6 mm

Speed: Up to 5000 stitches per minute, depending on thread, fabric and sewing operation.

**TN-747D:** This model is a 4 thread, two needle overcast machine used traditionally for knits and ready to wear.

Seam specification: ISO# 514 Overedge formed with 2 needle threads and 2 looper threads with the looper threads forming a purl on the edge of the seam. 514-both needles enter the upper looper loop.

Sewing capacity: up to 5mm

Standard needle: B27 (DCx27) #10/70~14/90

Stitch length: Up to 6 mm

Speed: Up to 5000 stitches per minute, depending on thread, fabric and sewing operation.

**TN-757D:** This model is a 5 thread, two needle overcast machine used traditionally for woven materials. This machine can be used in 3 thread overcast only and 5 thread overcast with a safety stitch. *This machine is not recommended for knits.*

Seam specification: ISO# 516 Safety Stitch 5-thread safety stitch. Combining a single-needle chainstitch (401) and a 3-thread overedge stitch (504) that are formed simultaneously.

Sewing capacity: up to 5mm

Standard needle: B27 (DCx27) #10/70~14/90

Stitch length: Up to 6 mm

Speed: Up to 5000 stitches per minute, depending on thread, fabric and sewing operation

## PARTS OF THE MACHINE

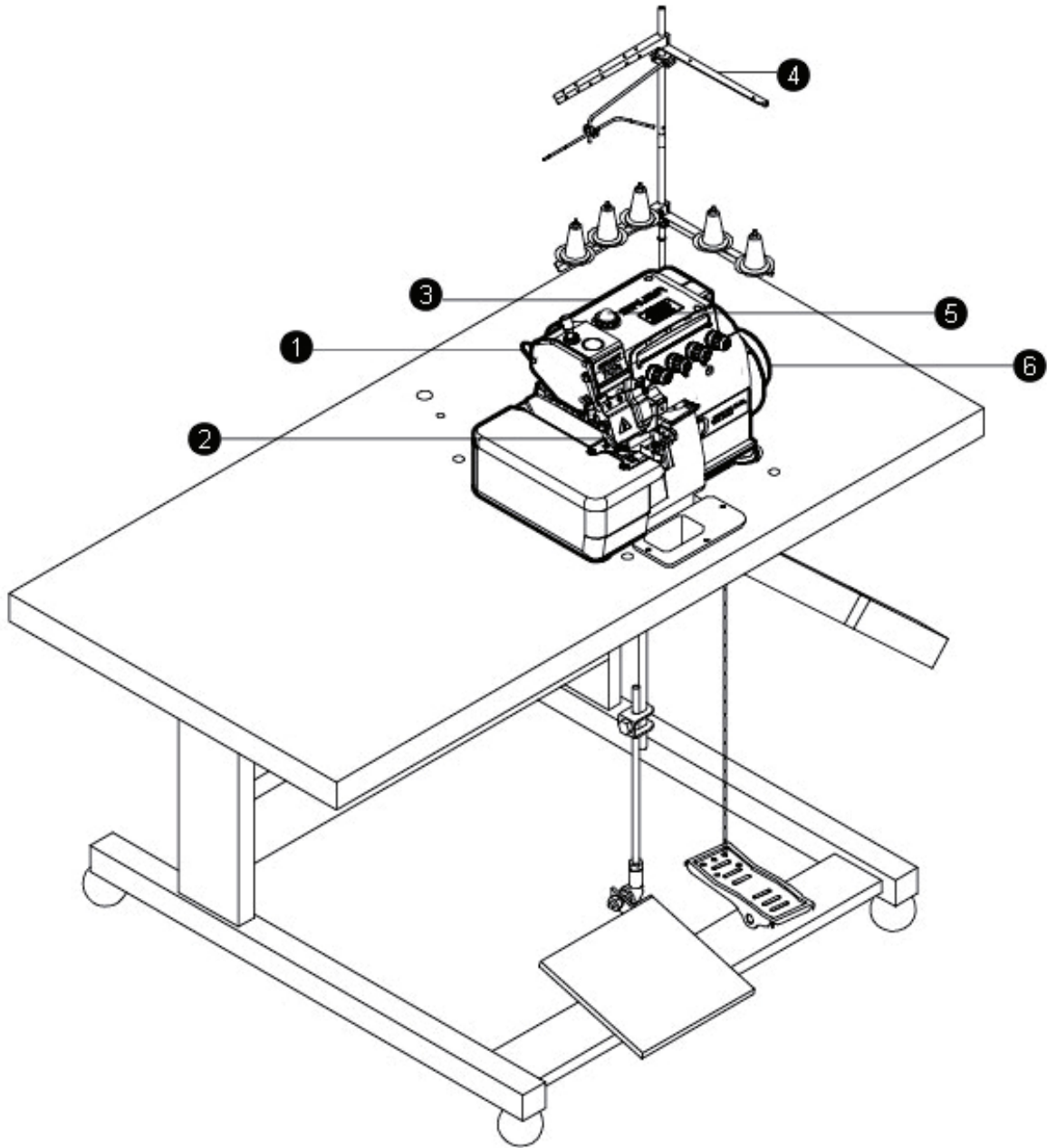

- (1) Lifting lever
- (2) Presser foot
- (3) Control box
- (4) Thread stand
- (5) Oil gauge window
- (6) Pulley (Hand Wheel)



## **INSTALLATION**

- Machine installation should only be carried out by a qualified technician.
- Contact your dealer or a qualified electrician for any electrical work that may need to be done.
- The sewing machine weighs 48kg. The installation should be carried out by two or more people.
- Do not connect the power cord until installation is complete. The machine may operate if the treadle is depressed by mistake, which could result in injury.
- Use both hands to hold the machine head when tilting it back or returning it to its original position. If only using one hand, the weight of the machine head may be too heavy to hold, and may cause human physical injuries
- Install the rubber cushion and the rest board in sequence as the attached table cut-out drawing and the part lists. In case of the semi-submerged type installation, the distance from the surface of the needle plate to the surface of the table is 100 mm, whereas the fully-submerged type installation is only 5 mm. Figure 1 shows a semi-submerged table top.

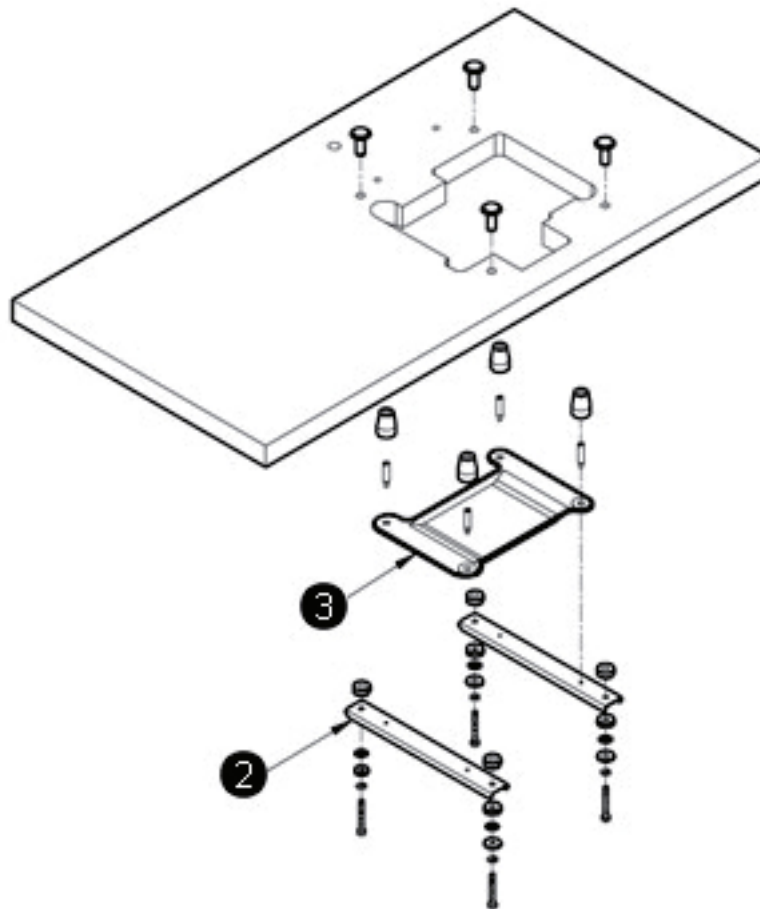

Figure 1

- Install the pedal of motor (4)(Fig. 2) on the left side, and the pedal of presser foot lift (5) on the right side.

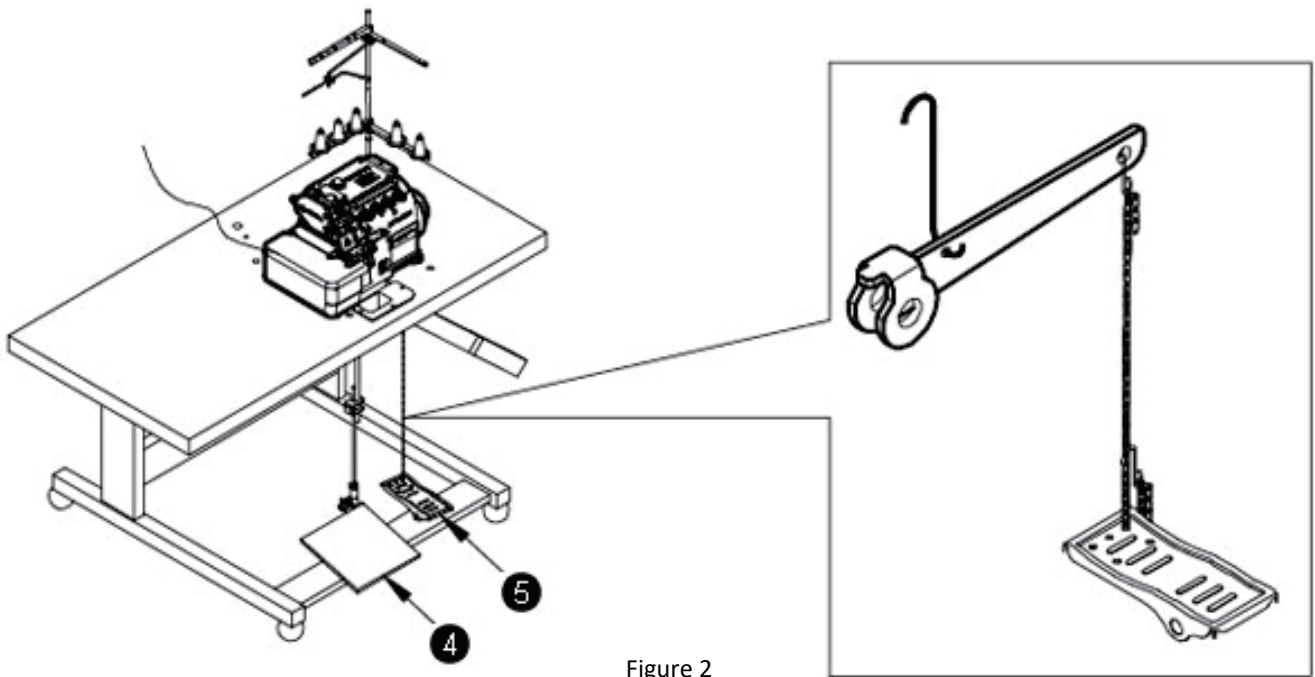

Figure 2

- Install the waste chute and the thread stand as the part lists show.

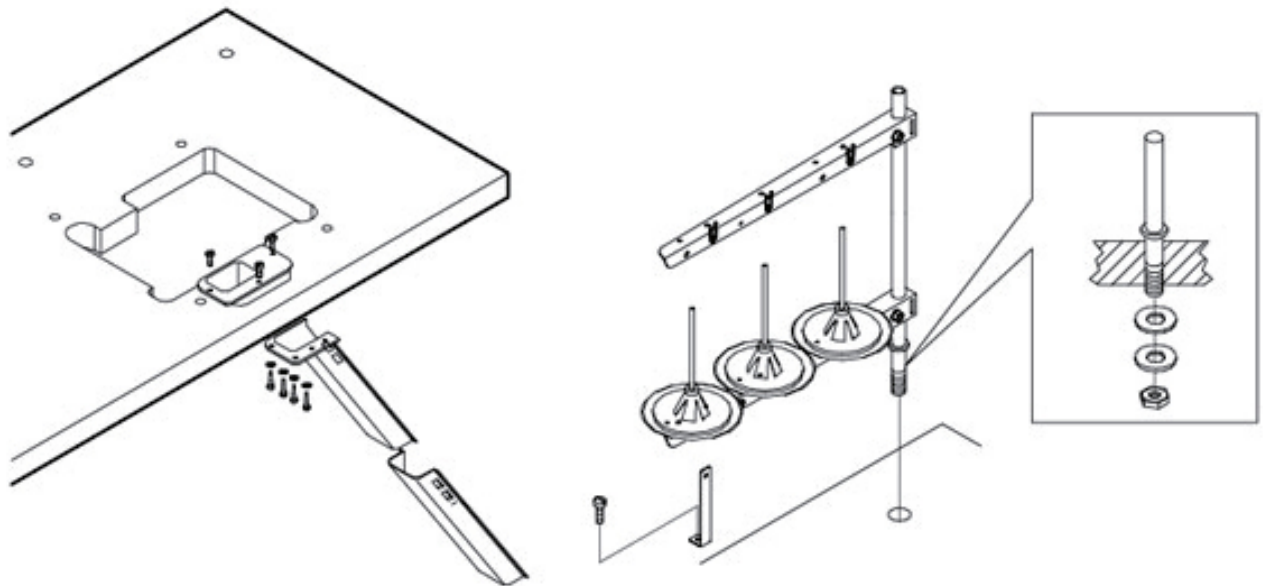

Figure 3

## **HANDLING YOUR MACHINE**

When lifting your machine in and out of your table or any other situation, please refer to (Fig. 4) for how to lift your machine. DO NOT lift the machine by the left base arm as in (Fig. 5)

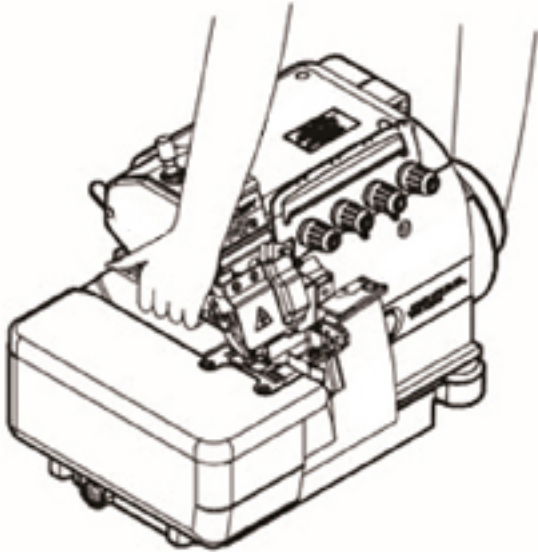

Figure 4

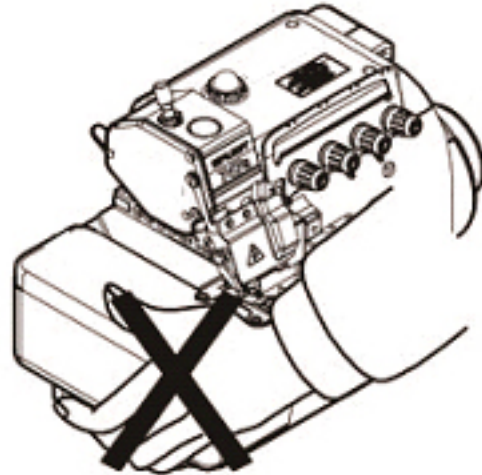

Figure 5

## **BREAK IN PERIOD**

Please operate this machine at 80% of the maximum speed in the first four weeks for engagement. This will help extend the life of your new machine and allow the machine to “break-in” all new parts.

## **LUBRICATION**

Fill the lubrication oil (Fig. 6)(1) Remove the screw (1), and fill it with the included high speed oil. Tighten the screw (1) after the oil level indicator locates between the two marking lines.

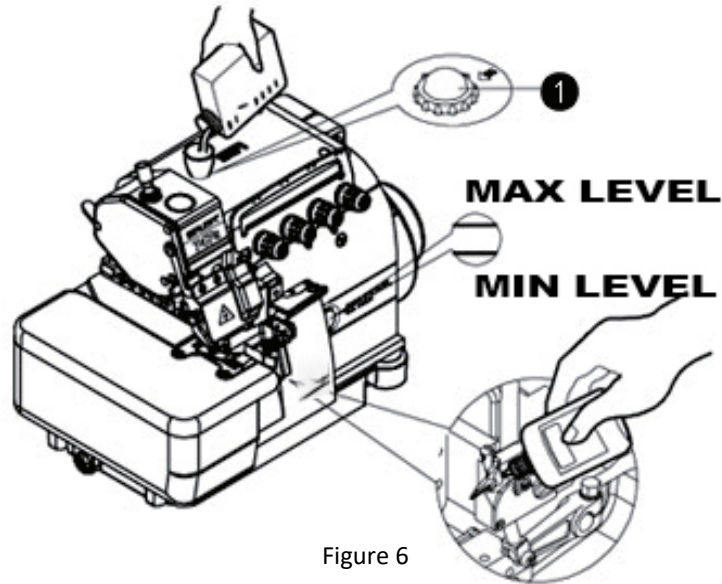

Figure 6

When changing the oil or simply draining the oil out of the machine, loosen screw (2) (Fig. 7). When removing the oil drain plug, make sure not to lose the drain plug washer.

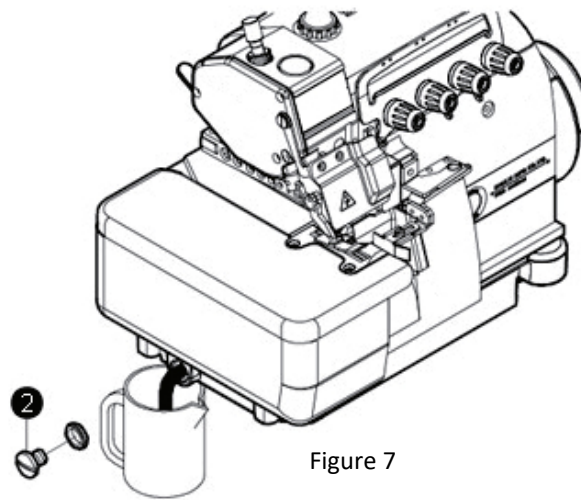

Figure 7

## **LUBRICATION (con't)**

When changing the filter (yearly maintenance), the cover is held in place by (3) screws. This cover is on the backside of the machine.

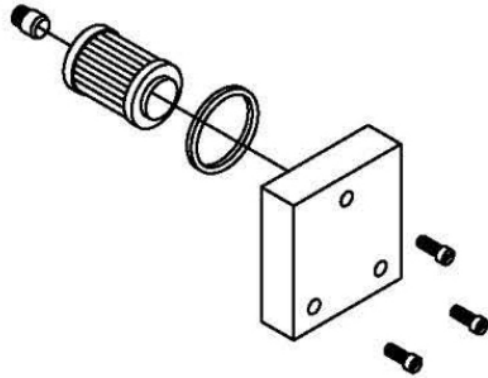
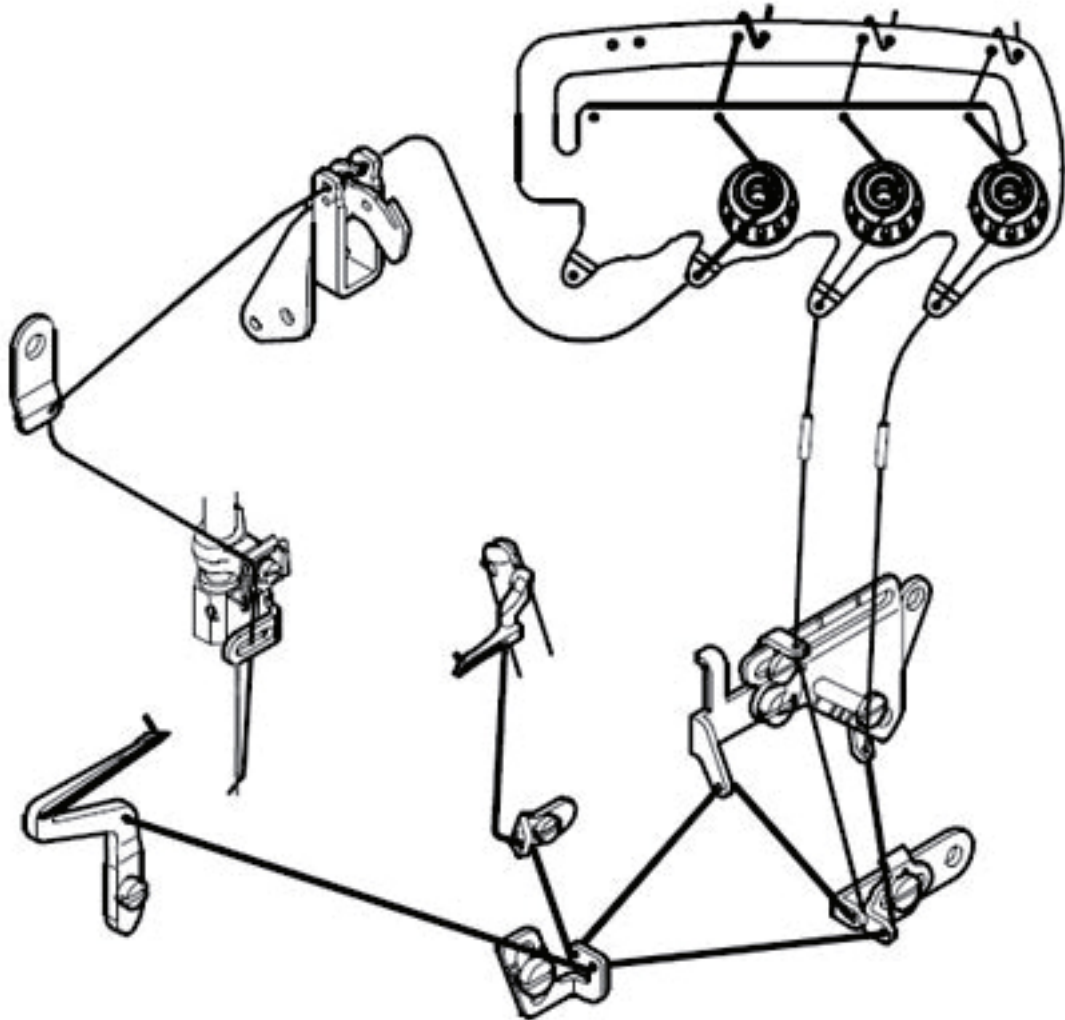

Figure 8

## THREADING

Follow the procedures for threading. Wrong threading may cause thread breaking, stitch skipping, puckering or unexpected sewing.



For three thread only 737 (Fig. 9)

**THREADING (Con't)**

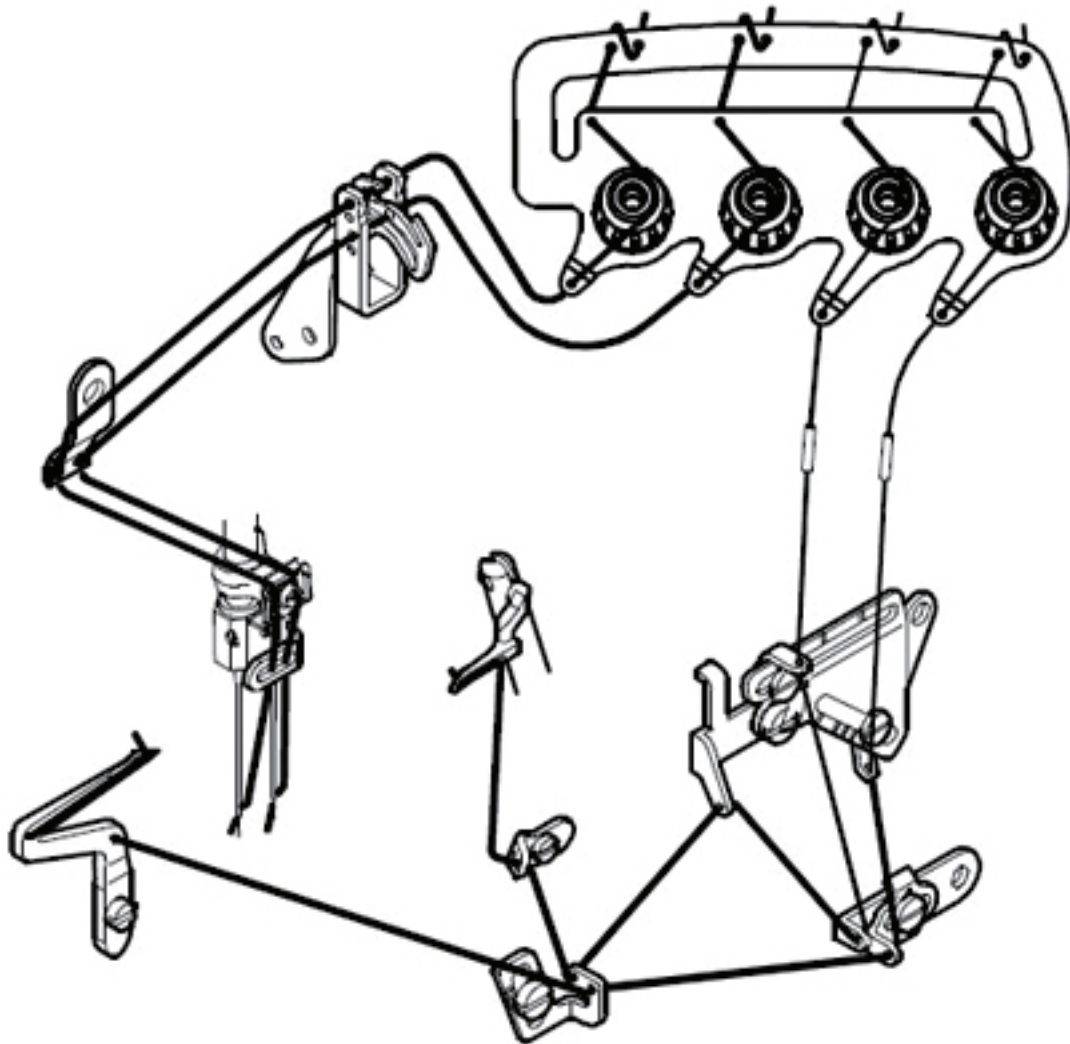

For four thread only 747 (Fig. 10)

**THREADING (Con't)**

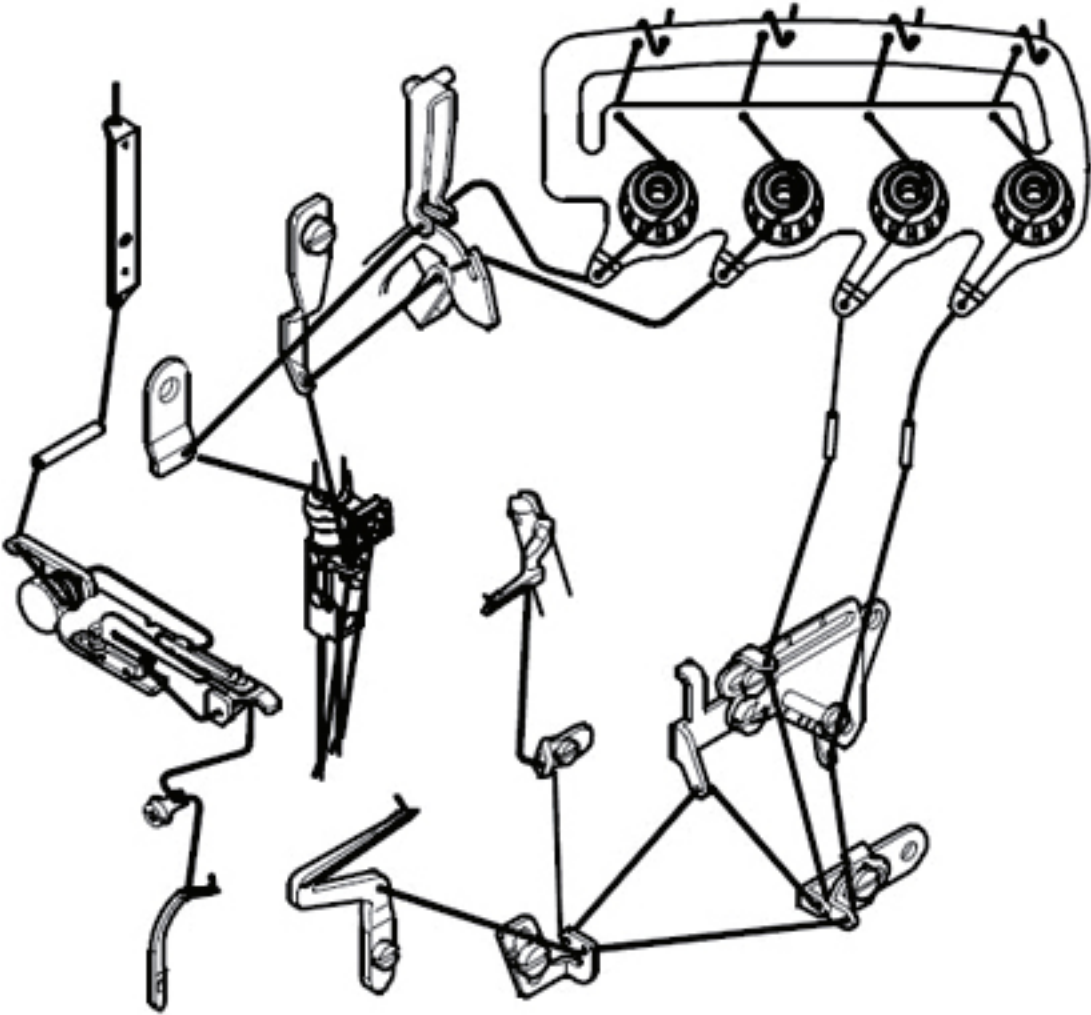

For five thread only 757 (Fig. 11)



## TENSIONS

The thread tension should be adjusted properly according to the kinds and the thickness of the materials, stitch length, and seam width, etc. In addition, adjust the nuts case by case individually. Turn the nuts clockwise will increase the thread tension. Otherwise, the thread tension will be decreased

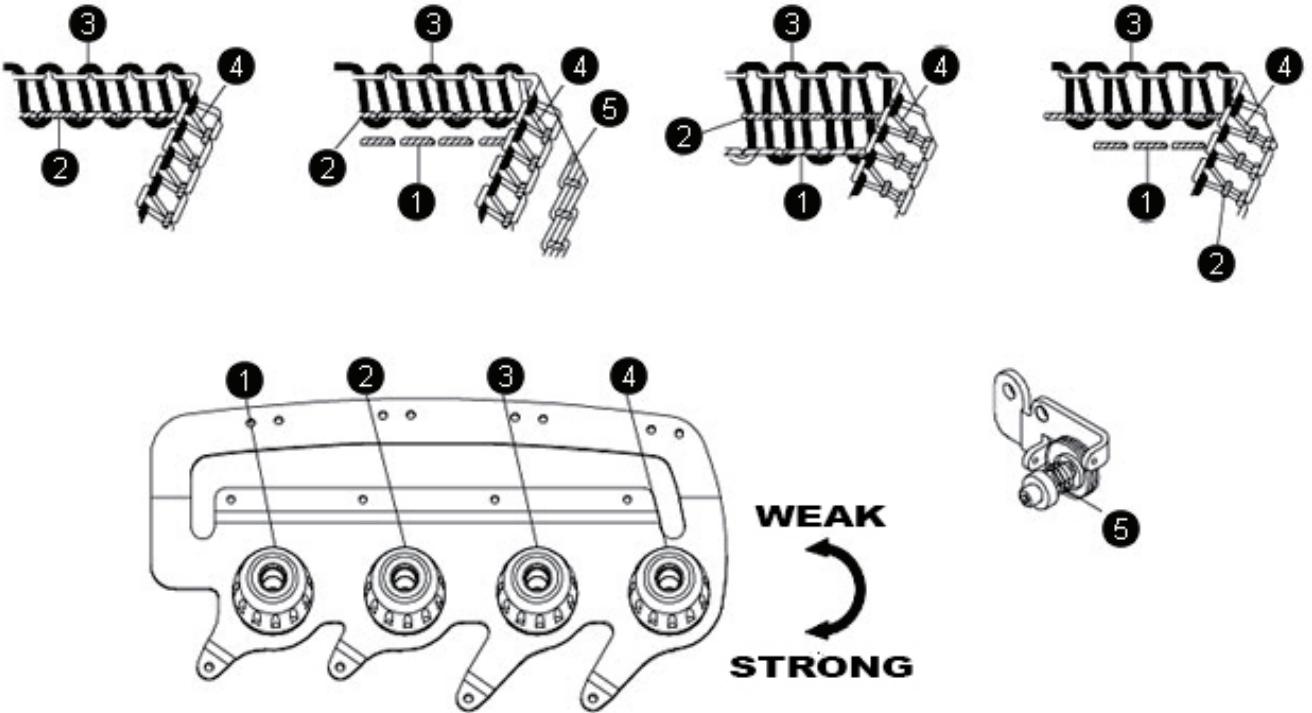

Thread tension adjusting nuts (Fig12)

- (1) The first adjusting knob controls double chain stitch threads (TN-757) or the left overlock needle thread (TN-747).
- (2) The second adjusting knob controls the seam lock needle thread.
- (3) The third adjusting knob controls the upper looper thread.
- (4) The fourth adjusting knob controls the lower looper thread.
- (5) The fifth adjusting knob controls the double chain looper thread.

## NEEDLES

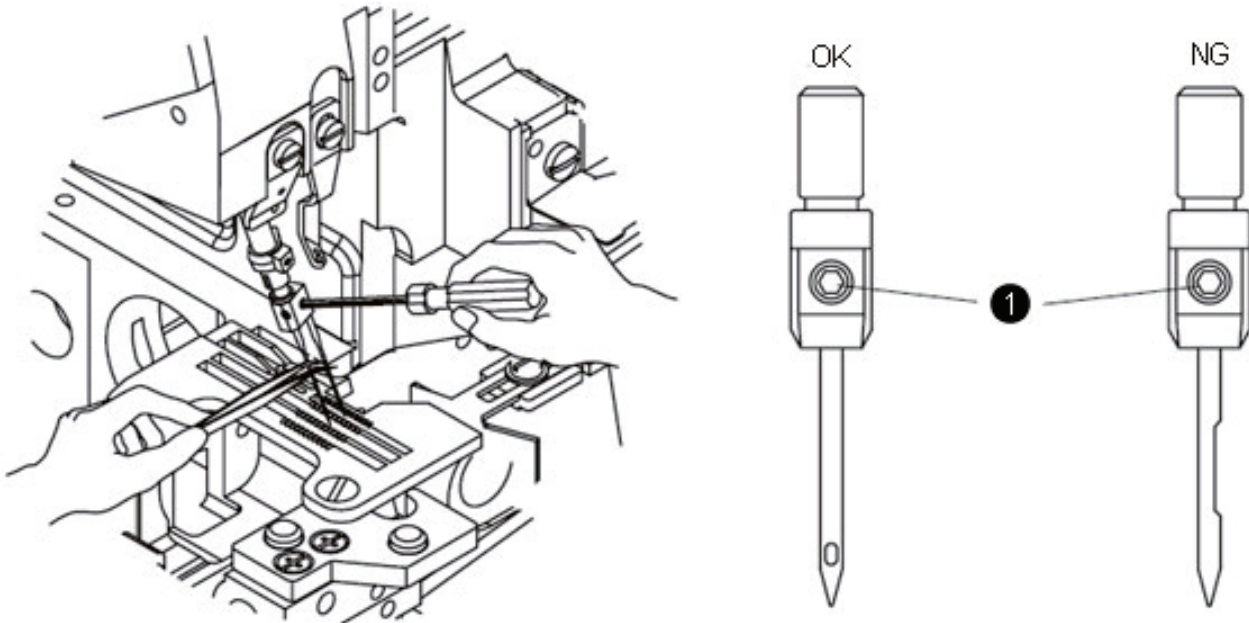

Figure 13

- Please use the needle DCX27 or the equivalents.
- Loosen the screw and take off the needle.
- Insert the new needle and push it up completely until the top of the needle is firmly seated as deep as it can travel into the needle bar. All needles should be installed with the scarf of the needle facing the back of the machine and the long groove faces your side.
- Tighten the screw (Fig.13)

CAUTION! Turn off main power switch before changing needles

## CHANGING THE STITCH LENGTH

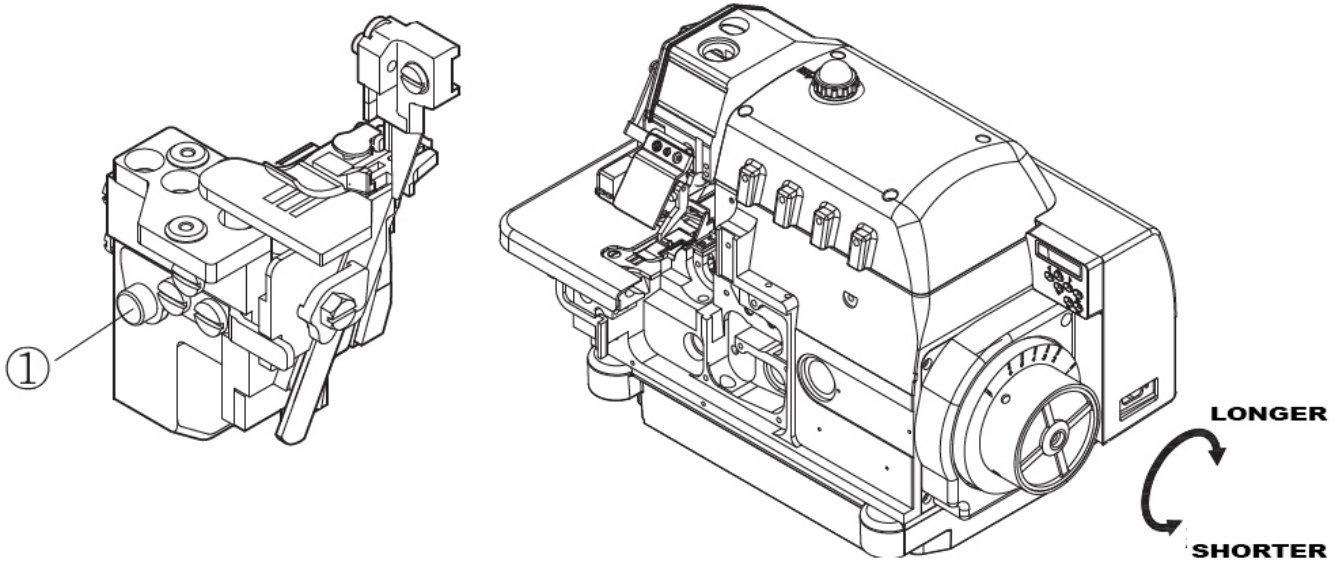

Figure 14

The stitch length is adjusted according to the fabrics, the differential ratio or other factors. Keep pressing the button (1) and turn the pulley till the button is locked. Then, release the button after reaching the desired stitch length. (Fig.14)

## CHANGING THE DIFFERENTIAL FEED

If the stroke of the main feed dog is larger than the stroke of the differential feed dog, the fabric will be extended while sewing. Otherwise, it will be shrunk

Loosen the adjusting nut (1) Adjust the adjusting rod (2) downward will shrink the fabric, whereas move it upward will extend the fabric. Tighten the adjusting nut (1) after the adjustment finishes. (Fig.15)

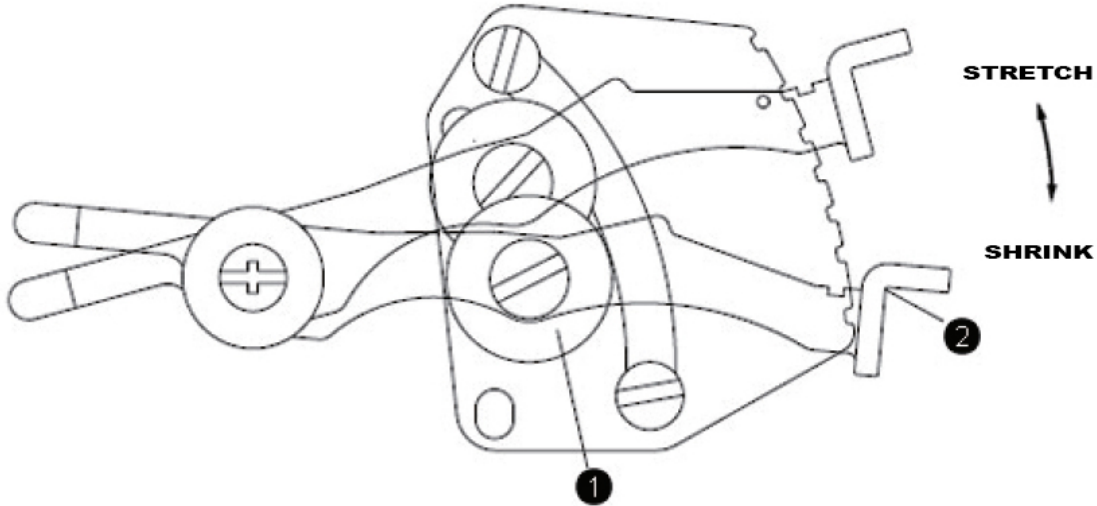

Figure 15

Scale		1	2	3	4	5
Differential feed ratio	1:1.3	-	1:0.7	1:0.9	1:1.1	1:1.3
	1:2	1:0.7	1:1	1:1.14	1:1.17	1:2
	1:3	1:1	1:1.5	1:2	1:2.5	1:3
	1:4	1:1.1	1:1.3	1:2.3	1:2.8	1:3.3

## ADJUSTING / REPLACING BLADES

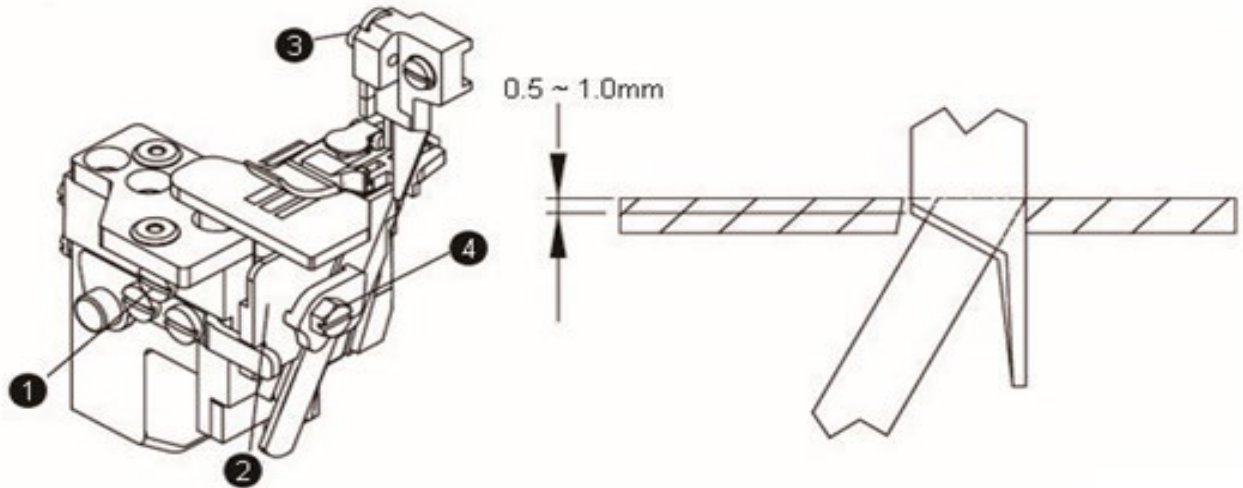

Figure 16

### REPLACE THE UPPER BLADE

- Loosen the screw **1** and move the lower blade holder **2** to the left. Then, tighten the screw **1** a little to hold the unit in place
- Remove the screw **3** and remove the old blade and put the new blade in. Then, tighten the screw **3** a little to hold the unit in place
- Turn the pulley to move the upper blade to the lowest dead point. Adjust the height of the upper blade so that the upper blade can cross the lower blade about 0.5 ~ 1.0 mm. After that, tighten the screw
- Loosen the screw **1** and return the lower blade to its original position. Test if the upper and the lower blade can cut appropriately, and then tighten the screw **1**

### REPLACE THE LOWER BLADE

- Loosen the screw **1** and move the lower trimmer holder **2** to the left. Then, tighten the screw **1** a little to hold the unit in place
- Loosen the screw **4** and take off the blade and replace with a new one  
Adjust the top edge of the lower blade to be align with the surface of the needle plate. Then, tighten the screw **4**  
Loosen the screw **1** to return the lower blade holder to its original position and test if the upper and the lower blade can cut appropriately then tighten the screw **1**

## **ADJUST THE HEM / CUTTING WIDTH**

- Turn the pulley to move the upper blade to the lower dead point.
  - Loosen the screw **1** and move the lower trimmer holder **2** to the left. Then, tighten the screw **1** a little to hold the unit in place
  - Loosen the screw **3** and move the upper blade holder left or right till reaching the desired width. Then, tighten the screw **3**
- Loosen the screw **1** to return the lower blade holder to its original position and test if the upper and the lower blade can cut appropriately then tighten the screw **1**

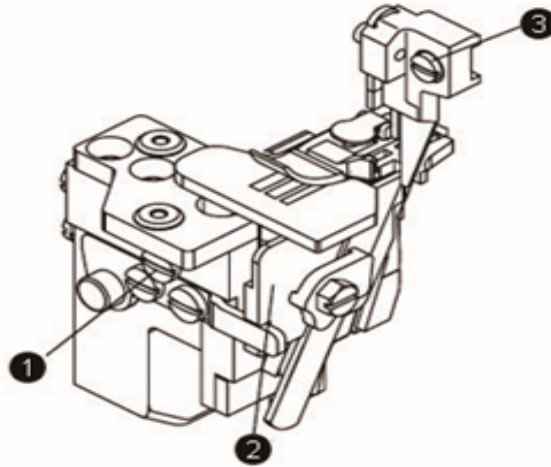

Figure 17

TITANSEWING.CA

866-469-1147

SALES@TITANSEWING.CA